

DRIE

TRANSFORMATOREN BV

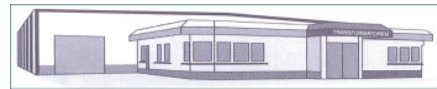

MAATVOERING RINGKERNTRANSFORMATOREN

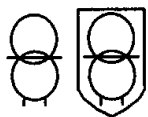
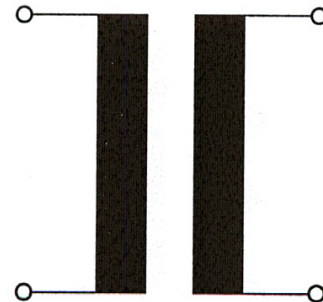
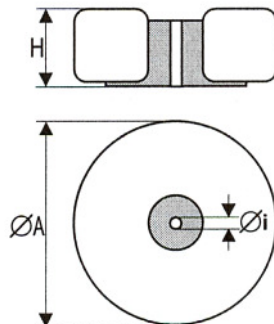

Ringkerntransformatoren met binnengat ingegoten

CE

Type	Vermogen	Afmetingen in ca. mm.			Totaal Gewicht ca. Kg.
		A	H	i	
RK-ISS/10	10 VA	58	30	0,40	
RK-ISS/20	20 VA	55	35	0,68	
RK-ISS/35	35 VA	70	34	0,69	
RK-ISS/50	50 VA	73	37	0,68	
RK-ISS/60	60 VA	75	44	0,88	
RK-ISS/75	75 VA	75	45	0,92	
RK-ISS/80	80 VA	76	48	0,96	
RK-ISS/100	100 VA	95	42	1,25	
RK-ISS/125	125 VA	95	45	1,25	
RK-ISS/160	160 VA	105	47	1,60	
RK-ISS/200	200 VA	110	50	2,00	
RK-ISS/250	250 VA	120	54	2,40	
RK-ISS/300	300 VA	120	62	3,00	
RK-ISS/400	400 VA	130	64	3,75	
RK-ISS/500	500 VA	138	68	4,16	
RK-ISS/630	630 VA	145	80	5,20	
RK-ISS/800	800 VA	162	72	6,30	
RK-ISS/1000	1,0 KVA	165	85	7,70	
RK-ISS/1300	1,3 KVA	182	89	10,0	
RK-ISS/1600	1,6 KVA	200	100	11,5	
RK-ISS/1900	1,9 KVA	210	100	13,7	
RK-ISS/2200	2,2 KVA	230	90	15,7	
RK-ISS/2500	2,5 KVA	200	105	17,1	

MAATVOERING EN GEWICHTEN ONDER VOORBEHOUD.

ROBI

DRIE Transformatoren BV, Postbus 55, 6980 AB DOESBURG, Tel.: 0313 - 41 55 00
Fax: 0313 - 41 22 77; Intern.: www.drietrafo.com ; E-mail: info@drietrafo.com.